

Section 9 - Repair Parts List

9.1 Wheels and Casters

PT Transport For model: CE50-100/100PT

1	Part no. SP-365	Caster-Swivel 8 x 3" TRB-Poly
2	Part no. SP-553	Wheel, 12" x 3" Poly, TRB



TW Transport For model: CE50-150/150TW

1	Part no. SP-270	Caster-Swivel 12" x 3" MO, RT, RB
2	Part no. SP-270-1	Wheel, 12" x 3" Rubber, Roller Bearing, 3 1/2" Hub Length, 1" Axle
3	Part no. SP-271	Wheel, 16" x 4" Rubber, Roller Bearing



9.2 CE50 PUMP For model: CE50-100/100PT, CE50-150/150TW

CE50 COMBINATION SUMP/CLEANER/FILTER - COOLANT DISPENSER
THREE PHASE ELECTRIC

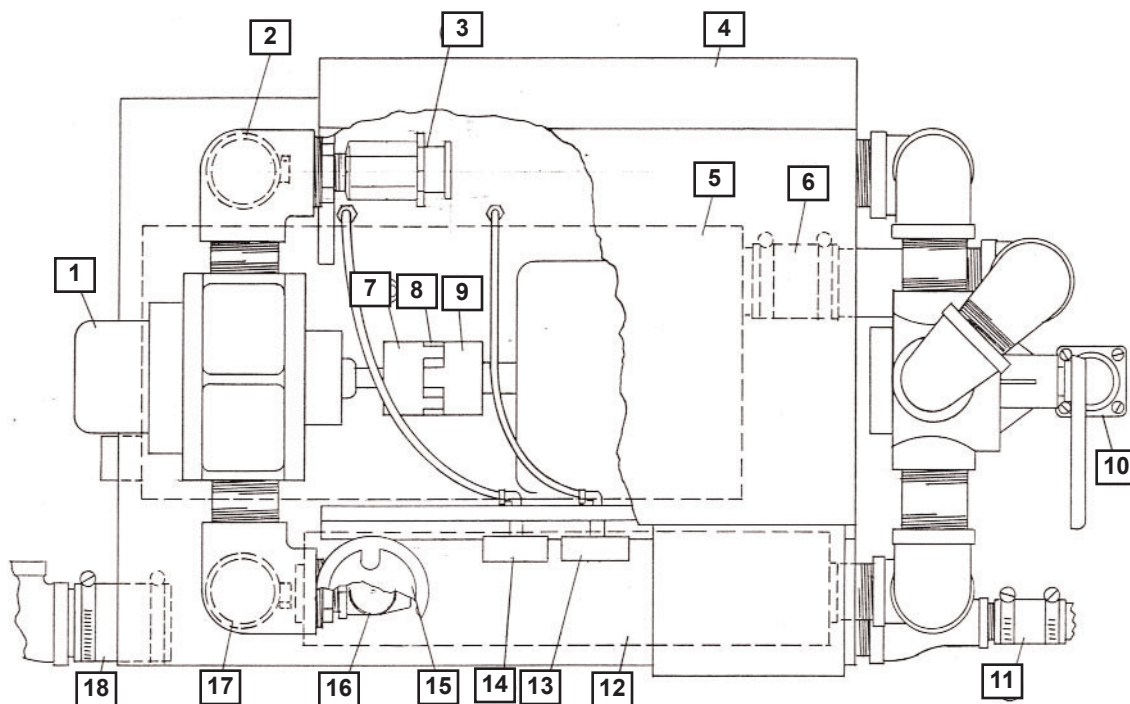

1	SP-388	Vacuum Pump
2	A220-277	Flexible Coupling Assembly, 2" Pipe
3	SP-506	Valve - Vacuum Relief, 1"
4	A220-278	Hood
5	SP-441	Muffler
6	A220-277	Flexible Coupling Assembly, 2" Pipe
7	SP-389	Flexible Coupling Body, 3/4" Bore
8	SP-390	Coupling Spider, Flexible
9	SP-391	Flexible Coupling Body, 1-1/8" Bore
10	SP-351	Liquid Level Gauge, 30"
11	A220-160	Flexible Coupling Assembly, 1" Pipe
12	SP-394	Muffler, 1-1/2", U5
13,14	SP-195	Vacuum Pressure Gauge, 2-1/2", Back Mount
15	SP-442	Muffler, 1", N10
16	SP-443	Pressure Relief Valve, 1", 7 psi
17, 18	A220-277	Flexible Coupling Assembly, 2" Pipe



9.3 TANK COMPONENTS

For Models: CE50-100/100PT, CE50-150/150TW

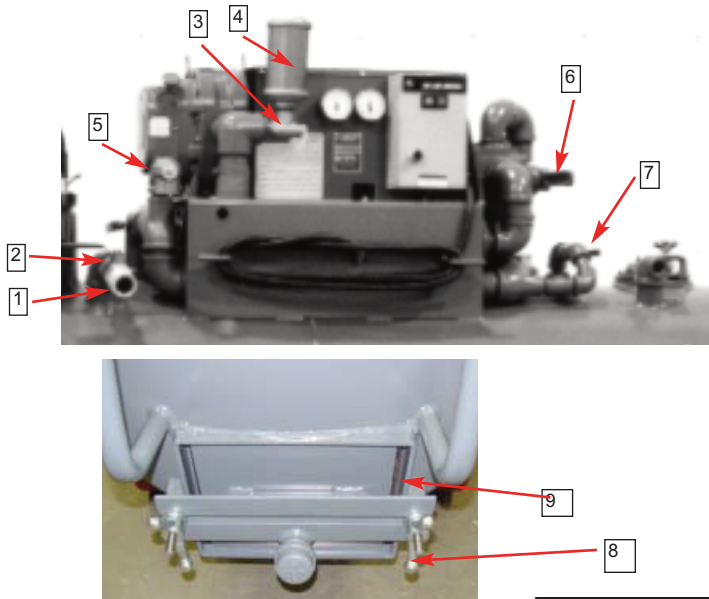

1	SP-375	Disconnect Adapter, 2", Male Threads,F
2	SP-466	Lever Operated 2". Valve
3	SP-443	Pressure Relief Valve, 1", 7 psi
4	SP-442	Muffler, 1"
5	SP-446	Pressure Relief Valve, 1-1/4" x 1-1/2",8 psi
6	SP-444	4-Way Valve
7	SP-463	Lever Operated, 1" Valve
8	SP-104	Wing Nut, 1/2-13
9	A210-165	Cleanout Door Gasket

9.4 F23 FILTER

For Models:
CE50-100/100PT
CE50-150/150TW



1		A210-431	Basket Assembly
2		B210-530	Strainer Bag 1.0 cu.ft.
2		A210-529C	Strainer Bag 1.0 cu. ft.
2		A210-529F	Strainer Bag 1.0 cu.ft.
3	See Photo.	F23 1-1/2" 24"	F23 Filter Option 90 Gallon Tanks
3	See Photo.	F23 1-1/2" 30"	F23 Filter Option 140, 175 Gallon
4		A220-101	Strainer Sleeve 2.3 cu.ft.
4		A220-560	Strainer Sleeve 2.3 cu.ft.
5		SP-104	Wing Nut 1/2-13
6		A220-103	Filter Lid Assembly F23 1-1/2
7		A220-102	Gasket, Filter Lid (F23) - 10-3/4 diam-
8		SP-405	Adapter, 1-1/2", Disconnect, Female
9		SP-452	Cap - Bleed Off 1-1/2"
10		SP-373	Security Chain with small hooks 6"



9.5 TOOLS AND ACCESSORIES

For Models: CE50-100/100PT, CE50-150/150TW

1		A-210-965	STRAIGHT NOZZLE (FITS 2" HOSE)
2		A-220-151	FLARE NOZZLE (FITS 2" HOSE)
3		A-220-152	FLEXIBLE NOZZLE (FITS 2" HOSE)
4		A-220-562	NOZZLE VALVE, 1"
5		A-220-147	HOSE ASSEMBLY, 2" I.D. X 16' LONG, CLEAR
5		A-220-147R	HOSE ASSEMBLY, 2" I.D. X 16' LONG, RED
6		A-220-145	DISPENSING HOSE ASSEMBLY, CLEAR, 1-1/4" I.D. X 16' LONG
7		SP-262-BN2	GASKET FOR 2" DISCONNECT SET
8		SP-198-2	DISCONNECT COUPER, 2", FEMALE THREADS
9		A-220-624	FLOOR SQUEEGEE, 2"

